

## 3S Reagents compatible with Metrohm's OMNIS titration platform

This short guide is intended to give instructions for opening a 3S reagent bottle and connect it to the Metrohm Omnis titrator. It also describes how to fill the integrated cartridge with absorber material.

**Safe** chemical handling: minimized risk of contamination through contact-free reagent exchange

**Smart** connection of chemical consumables: communication between the 3S cap and instrument software via RFID with a visual status indicator on the system

**Secure** information transfer: Direct RFID-based transfer of reagent data to instrument software for elimination of human error

### How to open a 3S reagent bottle

Remove originality ring completely.

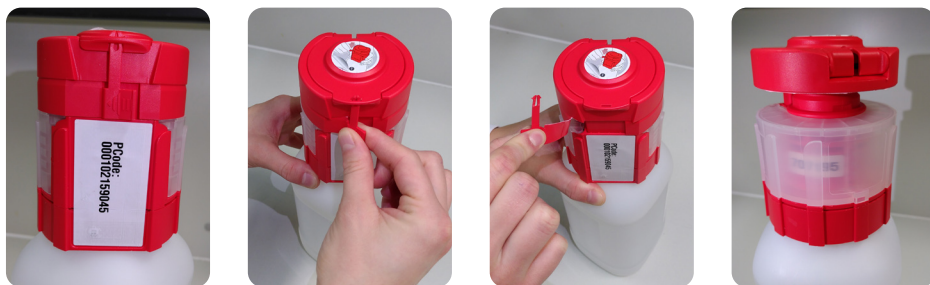

Open membrane by pressing down firmly (with snap-on lid closed and cartridge inserted).

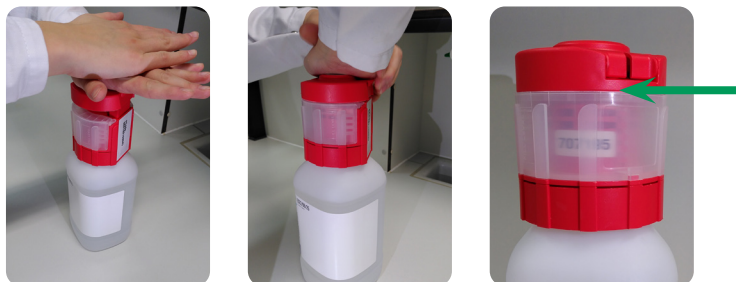

**ATTENTION:** The upper part of the cap must be completely pressed down, with a strong push. Make sure there is no gap between the transparent cartridge and the upper part of the cap (see green arrow).

CO<sub>2</sub>-sensitive reagents are delivered with a separate cartridge filled with fresh soda lime. Remove originality tape and insert the filled cartridge (incl. lid) into the 3S cap before carrying out the opening procedure of the bottle.

### How to connect the 3S reagent to the Omnis instrument

Open the snap-on lid and connect to the liquid adapter of the Metrohm Omnis instrument with a light single hand movement. See also our instructional video on [SigmaAldrich.com/3S](http://SigmaAldrich.com/3S)



### How to fill the cartridge with absorber material

(e.g. for CO<sub>2</sub>-sensitive reagents)

- Remove the cartridge from the cap and open the lid.
- Fill cartridge with absorber material (up to "Fill level" mark).
- Close the lid on the cartridge and insert back into the cap.



For more information, visit [SigmaAldrich.com/3S](http://SigmaAldrich.com/3S) and watch our instructional video.

MilliporeSigma  
400 Summit Drive  
Burlington, MA 01803

### To place an order or receive technical assistance

Order/Customer Service: [SigmaAldrich.com/order](http://SigmaAldrich.com/order)  
Technical Service: [SigmaAldrich.com/techservice](http://SigmaAldrich.com/techservice)  
Safety-related Information: [SigmaAldrich.com/safetycenter](http://SigmaAldrich.com/safetycenter)

[SigmaAldrich.com](http://SigmaAldrich.com)

